



1 Curlew Crescent WOODBERRY NSW

3 1 1

This classic, easy-care weatherboard and tile home is situated on a 474sqm corner block & provides the perfect opportunity for all buyers groups to enter into one of Maitland's most sought after suburbs.

Price : \$ 580,000

View : <https://www.dowlingnewcastlehunter.com.au/sale/nsw/hunter-valley-lower/woodberry/residential/house/7913929>

Welcome to 1 Curlew Crescent, Woodberry.

Charming, light filled, & spacious you will instantly fall in love with the practicality of the floorplan, the generous spaces, the open plan layout and a seamless flow of indoor living meets outdoor entertaining. The owners have reinvigorated this spectacular property and has made this one move in ready?.

Features Include:

- Updated kitchen with electric oven and plenty of storage.



Rob McCorrison
0406121166



SITE PLAN
(Not to Scale)

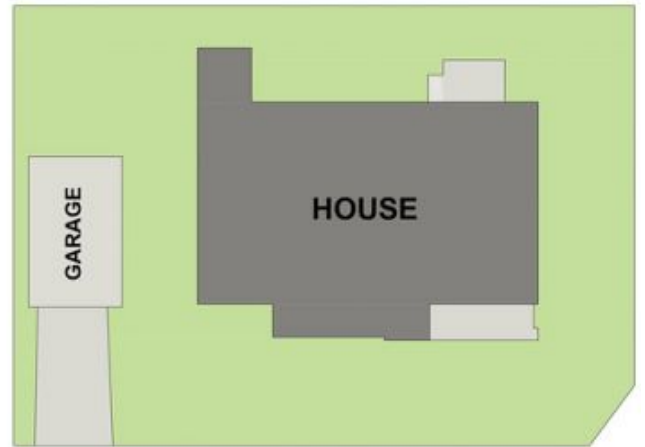

CURLEW CRESCENT

1 CURLEW CRESCENT, WOODBERRY

DISCLAIMER: FLOOR PLAN MEASUREMENTS ARE APPROXIMATE AND ARE FOR ILLUSTRATIVE PURPOSES ONLY. YOU SHOULD CONDUCT A CAREFUL INDEPENDENT INVESTIGATION OF THE PROPERTY TO DETERMINE SUITABILITY FOR YOUR SPACE REQUIREMENTS.